

User Manual

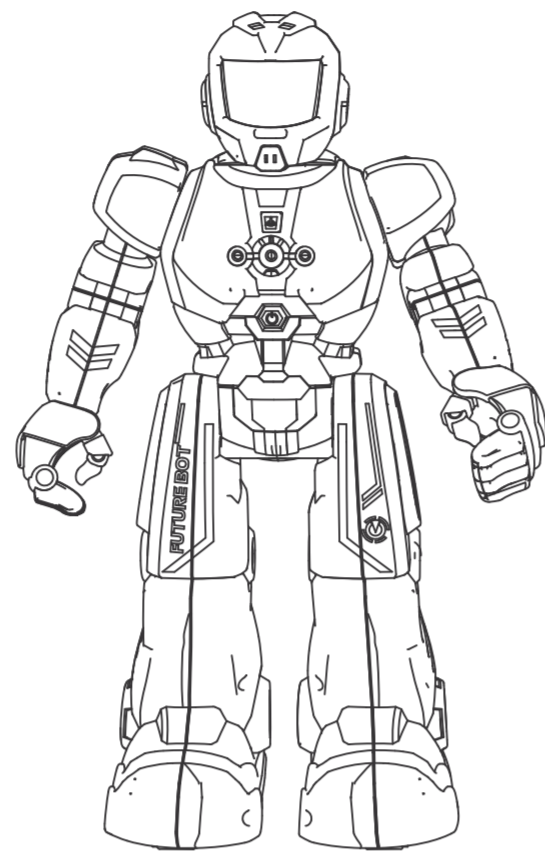

6088

If you have any questions about this product, please contact Ruko by sending a message to rukobrandstore@gmail.com

+86 19925221959 (Available from 9 pm to 6 am)

MULTI-FUNCTIONAL ROBOT INSTRUCTION

Remote Control Battery Explanation

- Before use, please install batteries:
- 1.Remote control needs 2 AAA batteries (2 x 1.5V AAA Battery)
- 2.Use Philip's type screwdriver to open the battery cover on the bottom of remote control.
- 3.Assemble the batteries with correct polarity.
- 4.Install the battery cover by fixing the screw.

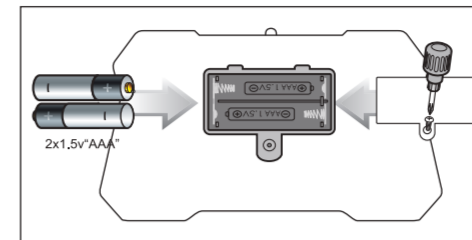

Battery Matters Need Attention

- 1.Recommend using Alkaline batteries.
- 2.Do not use rechargeable batteries.
- 3.Non-rechargeable battery cannot be charged.
- 4.The battery cannot be short circuit, break down, or into the fire.
- 5.Rechargeable batteries only can be charged under adult's supervision.
- 6.Rechargeable batteries should be removed from the toy before charging.
- 7.Battery should be assembled in the correct polarity.
- 8.Do not mix with different types of batteries or old and new batteries.
- 9.Can use the same and similar type of battery.
- 10.The exhausted batteries should be removed from the transmitter.
- 11.If non use for long time, please take out the battery from the transmitter.
- 12.Power terminal cannot be short circuit.
- 13.Do not use under the strong sunlight to make sure it can work well.

Robot Recharging

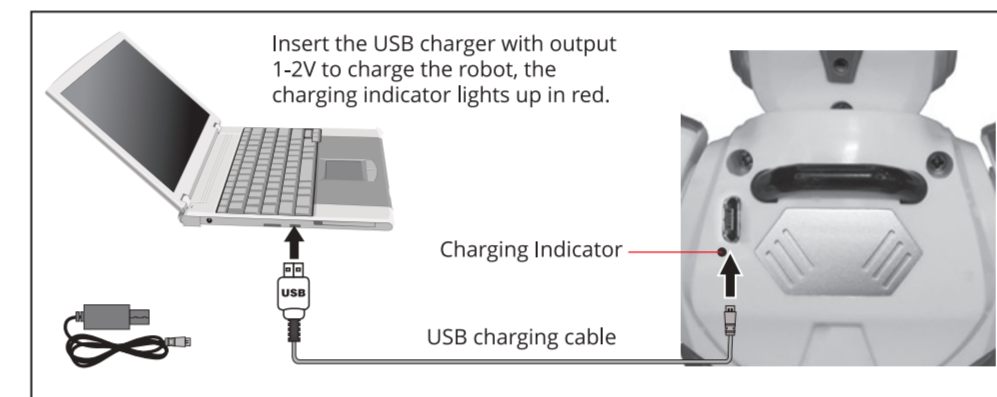

Batteries Charging

- 1.According to the direction of arrow, battery charger connected with the corresponding USB port.
- 2.Plug the charger to household electrical outlets.
- 3.Generally charge the battery for 2-3 hours, specially 3-4 hours at the first time.
- 4.The charging indicator will be off when the battery is full, and then unplug the charger; it's normal that the toy got slightly hot.

1

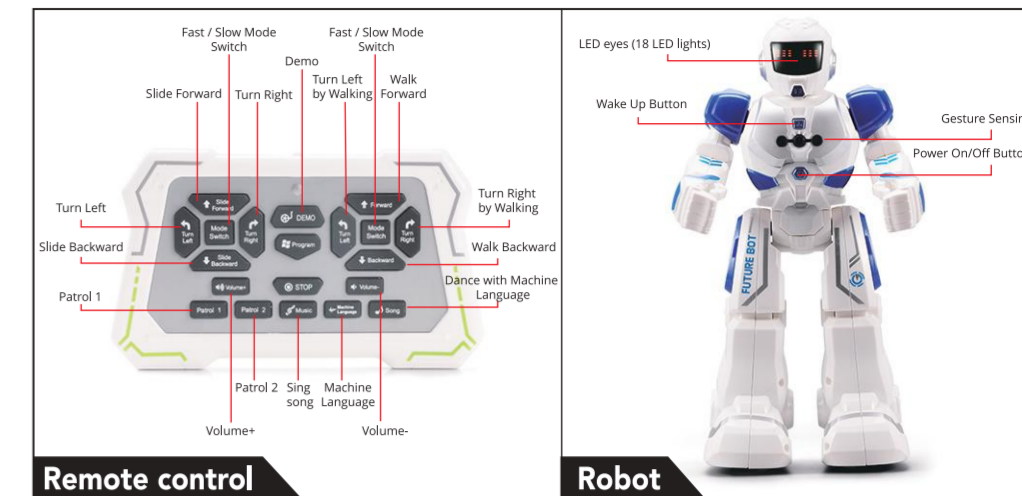

Functional Specification

- 1.Startup and Shutdown
Press the "Power On/Off" Button to active the boot state with voice and action, and then the robot transfers to the Standby Mode automatically if non-use; to power off the robot, press the "Power On/Off" Button again.

- 2.Standby Mode
In Boot State without any operation for 150 seconds, the robot will auto transfer to Standby Mode. Before Standby Mode, there are 3 kinds of voice sequentially broadcast every 20 seconds, 7 times in total. In Standby Mode, you cannot control the robot by remote controller, press the Wake Up Button once or Power On/Off Button twice to wake up the robot.

- 3.Forward
The robot walks forward with sound. When keep pressing the "Forward" button, it will walk forward continuously.

- 4.Backward
The robot walks backward with sound. When keep pressing the "Backward" button, it will walk backward continuously.

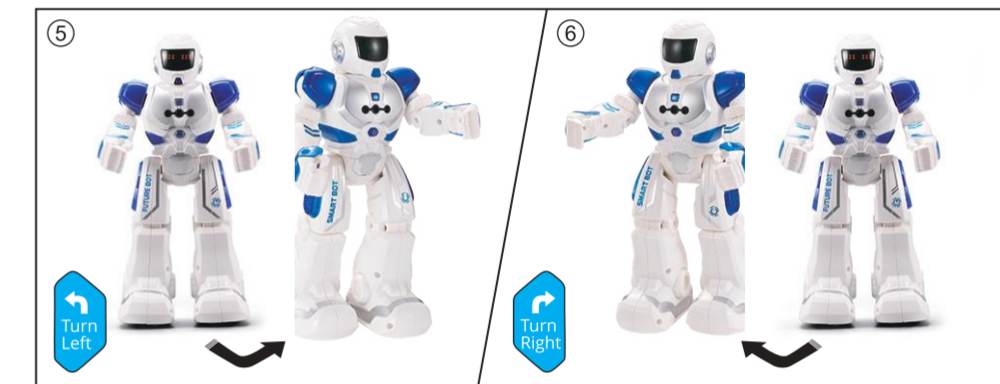

- 5.Turn Left (under Walking Mode on the right side of remote control)
The robot turns left by walking with sound.

2

- 6.Turn Right (under Walking Mode on the right side of remote control)
The robot turns right by walking with sound.

- 7.Mode Switch (under Walking Mode on the right side of remote control)
Press the button to select fast speed or slow speed for "Forward", "Backward", "Turn Left" and "Turn Right" under Walking Mode.

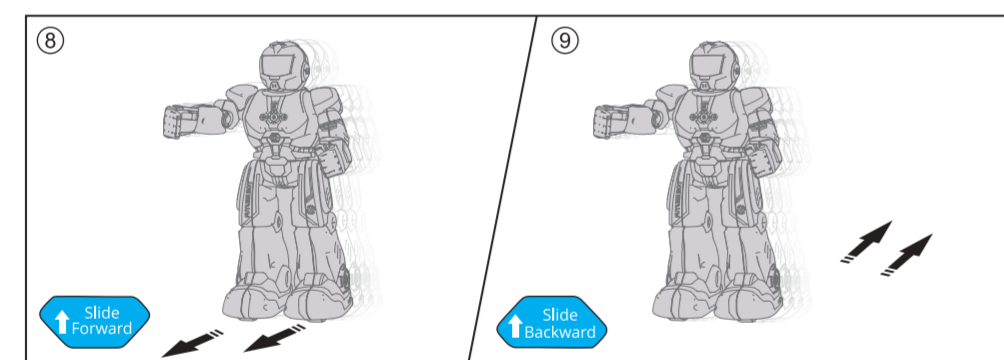

- 8.Slide Forward
The robot slides forward with sound. When keep pressing the "Slide Forward" button, it will slide forward continuously.

- 9.Slide Backward
The robot slides backward with sound. When keep pressing the "Slide backward" button, it will slide backward continuously.

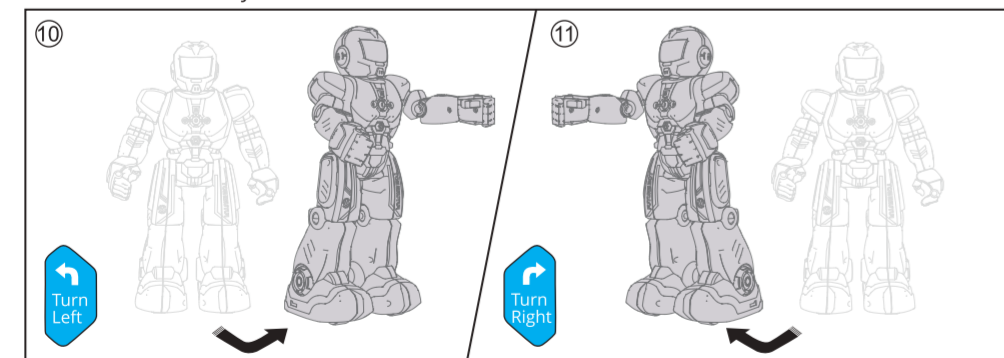

- 10.Turn Left (under Sliding Mode on the left side of remote control)
The robot turns left by sliding with sound.

- 11.Turn Right (under Sliding Mode on the left side of remote control)
The robot turns right by sliding with sound.

- 12.Mode Switch (under Sliding Mode on the left side of remote control)
Press the button to select fast speed or slow speed for "Slide Forward", "Slide Backward", "Turn Left" and "Turn Right" under Sliding Mode.

- 13.Volume + or Volume -
Total 7 volume levels can be selected, and the default volume is at #5 level. The button "Volume +" is only for increasing the volume level; and the button "Volume -" is for deducting the volume level.

- 14.STOP
The robot stops any action immediately.

3

- 15.Program
Press the button "Program" first time to start programming, you can choose different actions to be programmed on the remote control; press the button again to complete and the robot does the actions per requirement. Note: Max.50 actions can be programmed in a combination.

- 16.DEMO
The robot will conduct the preset demonstration, total 3 demonstrations can be selected.

- 17.Patrol 1 and Patrol 2
The robot will patrol with a machine language.

- 18.Music
The robot can broadcast 3 different songs.

- 19.Song
The robot will dance with a machine language.

- 20.Wake Up Button
Wake up the robot from Standby Mode.

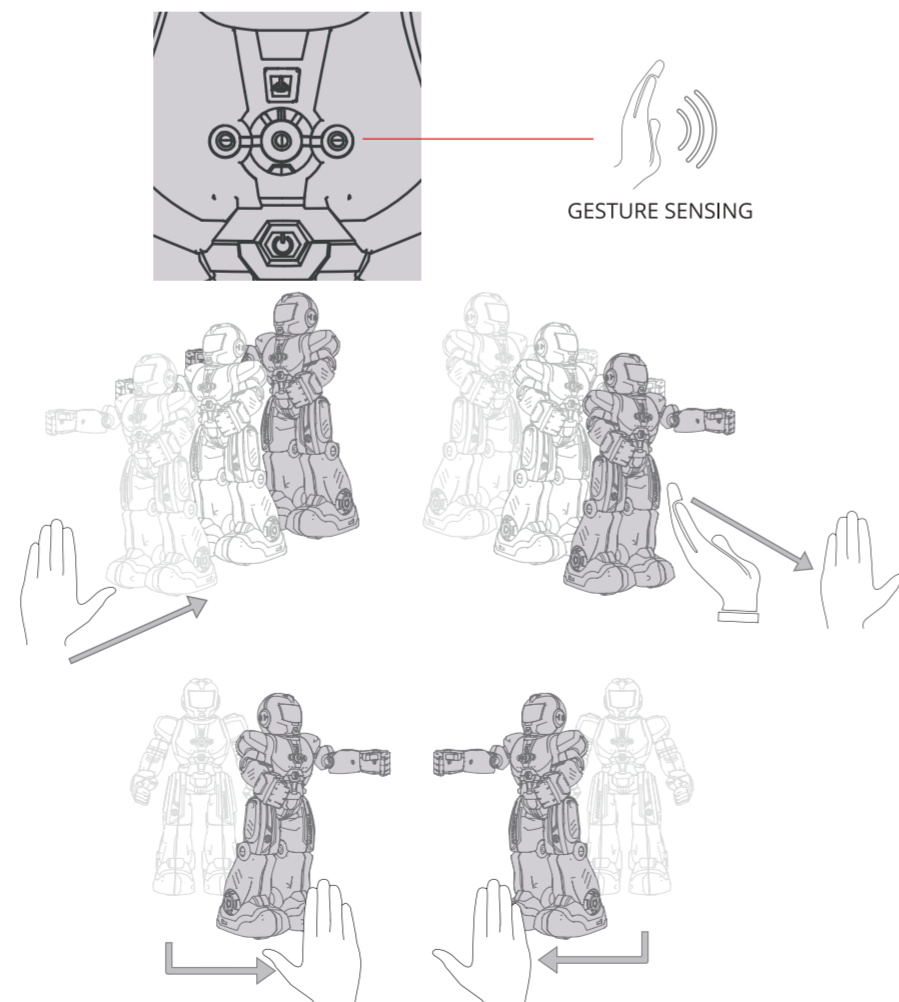

4

Important Notice

- 1.The robot cannot work under charging status.
- 2.The distance with remote control: 3-5 meters
- 3.Charging time: around 2-3 hours
- 4.Use time: around 2 hours
- 5.Standby Mode: around 30 days
- 6.The robot will automatically transfer to Standby Mode after 150 seconds without operation.
- 7.The charging indicator beside the USB port will be off if the battery fully charged.

CAUTIONS

- 1.Use Alkaline batteries recommend.
- 2.Do not mix with old and new batteries.
- 3.Do not mix Alkaline, standard (carbon zinc), or rechargeable (nickel-cadmium) batteries.
4. Non-rechargeable batteries are not to be recharged.
- 5.Rechargeable batteries not commended.
- 6.Batteries should be inserted or replaced by adults because of small and chokeable parts.
- 7.Remove batteries from the product before extended storage.
- 8.Exhausted batteries are not to be removed from the toy.
- 9.Batteries are to be inserted with the correct polarity.
- 10.Only batteries of the same of equivalent type as recommended are to be used.
- 11.Check and replace batteries periodically to prevent corrosion.
- 12.Supply terminals are not to be short-circuited.
- 13.Keep away from extreme heat.
- 14.Do not dispose of batteries in fire.
- 15.Please keep this information for future reference.

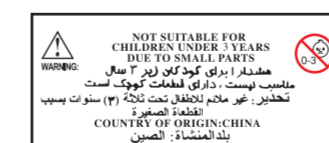

※ SPECIFICATIONS, COLORS AND CONTENTS MAY VARY FROM PHOTO.

NOT SUITABLE FOR CHILDREN UNDER 3 YEARS
NO CONVIENE A NINOS MENORES DE 3 YEARS
NO N ADATTO AI BAMBINI DI ETA INFERIORE AI 3 YEARS

5

Manufacturer: Guangdong Amwell Toys Industry Co.,Ltd
Address : Xingda Industrial Park, Fengxiang, Chenghai, Shantou City, Guangdong Province, China.

NO. 6088     
MADE IN CHINA

6